

Varifocal Board Camera

Products List > F Series > Board & Metal Camera > Varifocal Board Camera > MTC-807Q2V38

MTC-807Q2V38

FEATURES

MTC-807Q2V38



MTC-807Q2V38

- ◆ 1/3" Super High Res. Varifocal Board Camera
- ◆ Sony Super HAD CCD II
- ◆ Sony HQ1/ 540TVL/ 0.1Lux@F1.2
- ◆ AES/BLC/FL/AGC (ON/OFF)
- ◆ Built-in DNR & Sense Up
- ◆ 38(W)x38(H)x44(D)mm/ 30g
- ◆ 12Vdc/ 2.2W

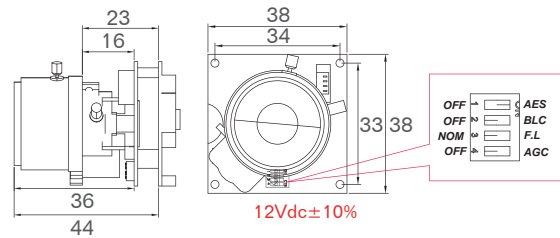

Tol: ±0.5 Unit:mm

SPECIFICATIONS

MTC-807Q2V38	
	PAL NTSC
TV System	PAL NTSC
Image Sensor	1/3" Sony Super HAD CCD II
Number of Total Pixels	795(H)x596(V) 811(H)x508(V)
Resolution ; DSP	540TVL ; Sony HQ1
Minimum Illumination	0.1Lux@F1.2
Video Output	1.0Vp-p Composite, 75Ω
Signal to Noise Ratio	More than 50dB (AGC off)
Gamma Correction	0.45
Synchronizing System	Internal
Automatic Electronic Shutter	ON:1/50(60)sec.~1/100,000sec. / OFF:1/50(60)sec.
Automatic Gain Control	ON / OFF
Automatic White Balance	AWB / AWC (Push-Lock)
Back Light Compensation	ON / OFF
Flickerless	ON / OFF
DNR ; Sense Up	Automatic Dynamic Digital Noise Reduction (DNR) ; Automatic
Digital Day&Night Mode	NA
Automatic IRIS	DC
Adjustment VR	DC Level
Lens Mount	Built-in DC Auto IRIS Lens
Lens, Angle of View(H)	Standard: f2.8~10mm/F1.2/94.6°~28.8° Option: Aspherical Auto IRIS Lens f2.5~6.0mm/F1.3/108.2°~47.6°
Power Supply ; Consumption	12Vdc±10% ; 2.2 W(180mA)
Operation ; Storage Temp.	-10°C~50°C ; -20°C~60°C
Operation ; Storage Humidity	Maximum:RH80% ; RH90%
Dimensions	38(W)x38(H)x44(D)mm
Net Weight	30g
Accessories Series Option(Page)	NA



10V21

Board & Metal Camera