

Color Board Camera

Products List > C Series > Board & Metal Camera > Color Board Camera > MTC-808H, MTC-806

MTC-808H, MTC-806

FEATURES



MTC-808H



MTC-806



Option:



Super Wide Angle (122°)
f2.1mm



38(W)x38(L)x22(H)mm

MTC-808H

- ◆ 1/3" Hi-Res. Color Board Camera
- ◆ 510TVL/ 0.3Lux@F2.0
- ◆ Built-in DNR & Sense Up
- ◆ Option: Super Wide Angle Lens

MTC-806

- ◆ 1/3" Med-Res. Color Board Camera
- ◆ 420TVL/ 0.15Lux@F2.0
- ◆ Built-in DNR & Sense Up
- ◆ Option: Super Wide Angle Lens

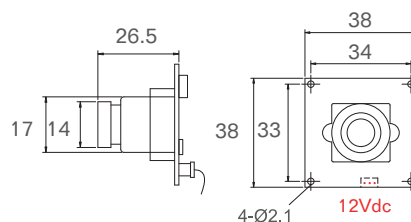

Tol: ±0.5 Unit:mm

SPECIFICATIONS

	MTC-808H		MTC-806	
TV System	PAL	NTSC	PAL	NTSC
Image Sensor	1/3" SONY Super HAD II CCD			
Number of Total Pixels	795(H)x596(V)	811(H)x508(V)	537(H)x597(V)	537(H)x505(V)
Resolution	510TVL		420TVL	
Minimum Illumination	0.3Lux@F2.0		0.15Lux@F2.0	
Video Output	1.0Vp-p Composite, 75Ω			
Signal to Noise Ratio	More than 50dB			
Gamma Correction	0.45			
Synchronizing System	Internal			
Automatic Electronic Shutter	Automatic			
Automatic Gain Control	Automatic			
Automatic White Balance	Automatic			
Back Light Compensation	NA		Automatic	
Flickerless	NA			
DNR ; Sense Up	Automatic Dynamic Digital Noise Reduction (DNR) ; Automatic			
Digital Day&Night Mode	NA			
Automatic IRIS	NA			
Adjustment VR	NA			
Lens Mount	Built-in Board Lens			
Lens, Angle of View(H)	Standard:f3.6mm/F2.0/72.5° Options: f2.5mm/105°, f2.9mm/90°, f6.0mm/47.5°, f8.0mm/36.5°, f12.0mm/24.5° Pinhole Lens Option:f3.7 or 4.3mm/F2.0 ; Options: Super Wide Angle f2.1mm/122°			
Power Supply ; Consumption	12Vdc ; 1.3W		12Vdc ; 1.5W	
Operation ; Storage Temp.	-10°C~50°C ; -20°C~60°C			
Operation ; Storage Humidity	Maximum:RH80% ; RH90%			
Dimensions	38(W)x38(H)mm			
Net Weight	15g			
Accessories Series Option(Page)	NA			